

CITY COUNCIL REPORT



Meeting Date: February 1, 2016

Honorable Mayor and City Council Members,

On your agenda for the February 1, 2016 Study Session the item **Northeast Downtown Parking Deficiency Solutions** appears. I will present information pertaining to the existing daytime parking deficiencies in Downtown Scottsdale, east of Scottsdale Road and north of Third Avenue. Dan Worth, Public Works Director, and I will also present potential short-term and long-term solutions to this deficiency. Representatives of the Economic Development Department, Planning and Development Division, Police Department, City Attorney's Office, City Treasurer's Office, and City Manager's Office will be present to assist with the discussion.

Dan and I will provide the presentation in your supplemental packet prior to the meeting

Please contact me if you have any questions or if I can be of assistance prior to the meeting.

Paul Basha, Transportation Director, 480-312-7651, pbasha@scottsdaleaz.gov

Downtown Scottsdale Parking Challenges and Solutions

Tonight's Discussion

- 1. Downtown Parking History**
- 2. Current Challenges**
- 3. Parking Data**
- 4. Short-term Recommendations**
- 5. Mid-term Recommendations**

Downtown Parking History

1962: 1st Parking Ordinance and Exempt C-2

1964: Parking Overlay

1965: P-1 and P-2

1966: P-3

1967: Remove C-2 Exemption

1969: Comprehensive Zoning Ordinance

1970: On-Street Angle Parking Credit

1972: P-3 Parking Credit

1974: Parking Improvement Districts

1981: Remote Parking Provisions

Downtown Parking History

- 1985: In-Lieu Payment Parking Created**
- 1995: Comprehensive Amendments**
- 2003: Angle Parking Credit Removed**
- 2003: Simplified Parking Requirements**
- 2006: Parking Requirements Amendments**

1,585 Parking Space Credits

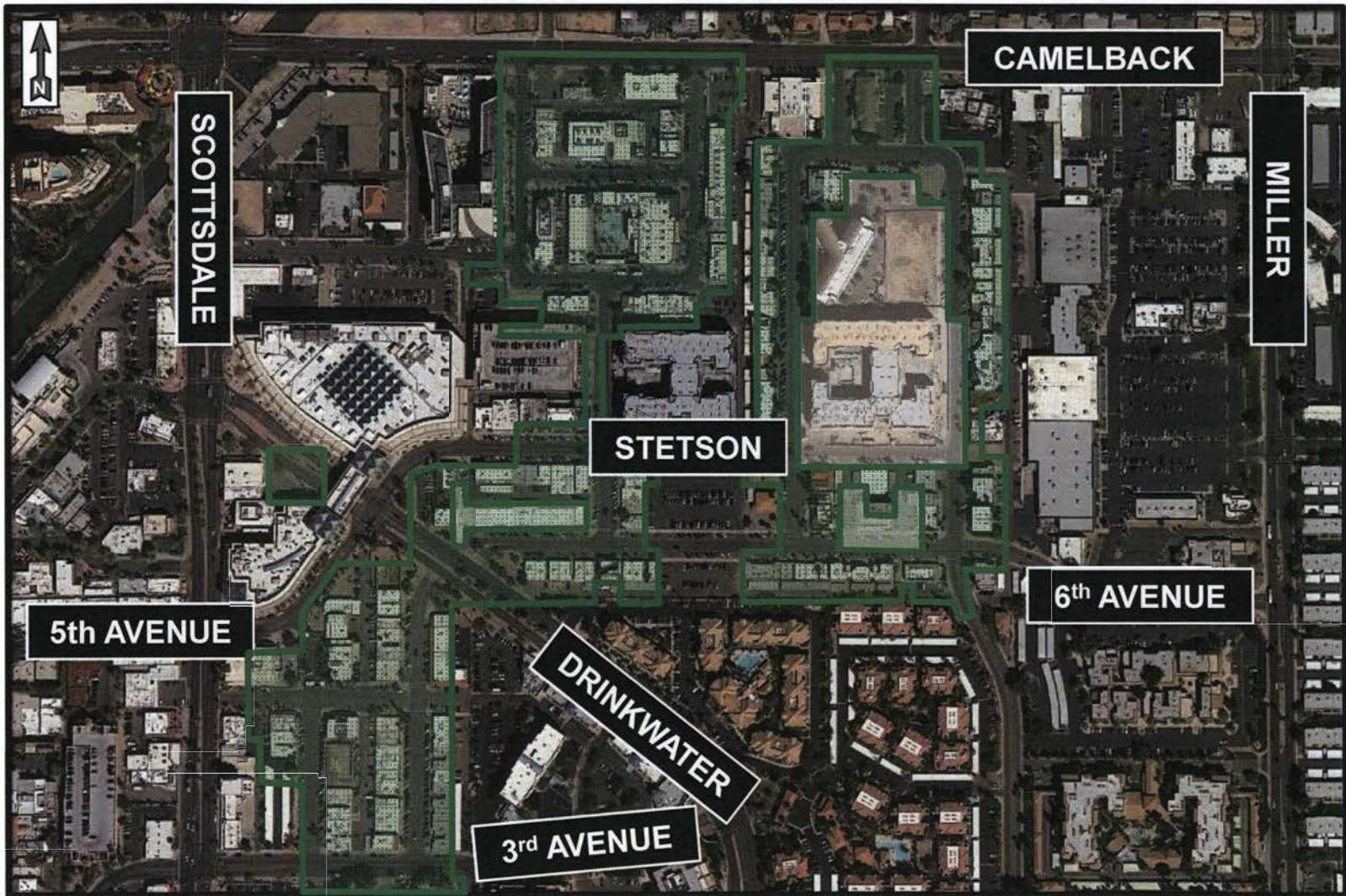

Changing Office Use

Nationally businesses use smaller individual offices with larger common areas

Competing cities have:

Lower parking requirements

Subsidized parking availability

More transit options

Consultant Parking Data

Detailed Downtown Parking Inventory

~ 20,000 Spaces Entire Downtown

~ Half Public, Half Private

Large number of 3-hour restricted spaces

Detailed Parking Occupancy counts

Validated and identified deficiencies

Consultant Parking Report

22 Nation-wide Best Practices
9-page Potential Solutions Discussion



CAMELBACK

INDIAN SCHOOL

DRINKWATER

SCOTTSDALE

GOLDWATER

Northeast Downtown



Available Parking Spaces



5th Avenue Parking Structure

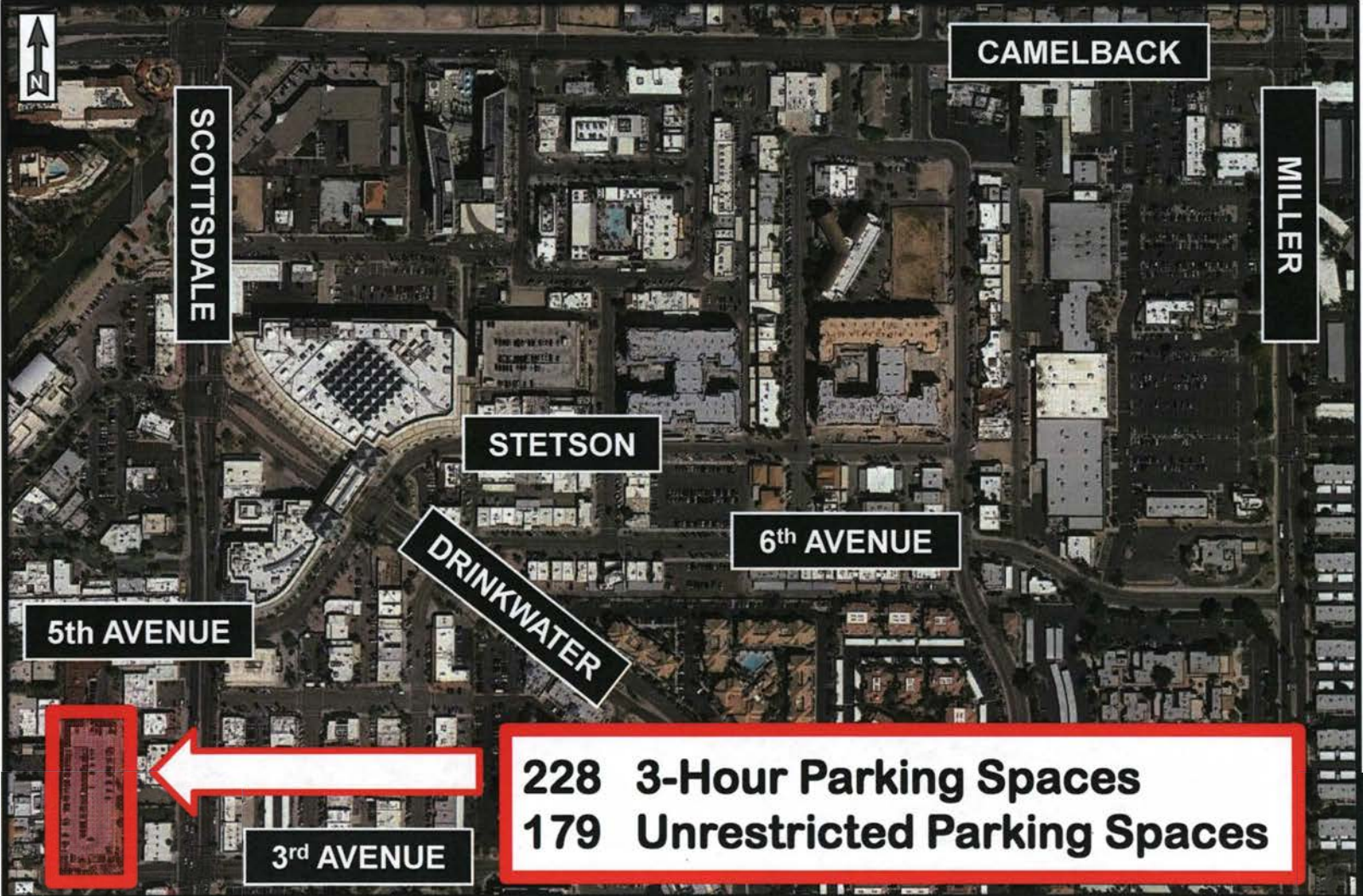

Downtown Parking Structures



Historic Parking Citations

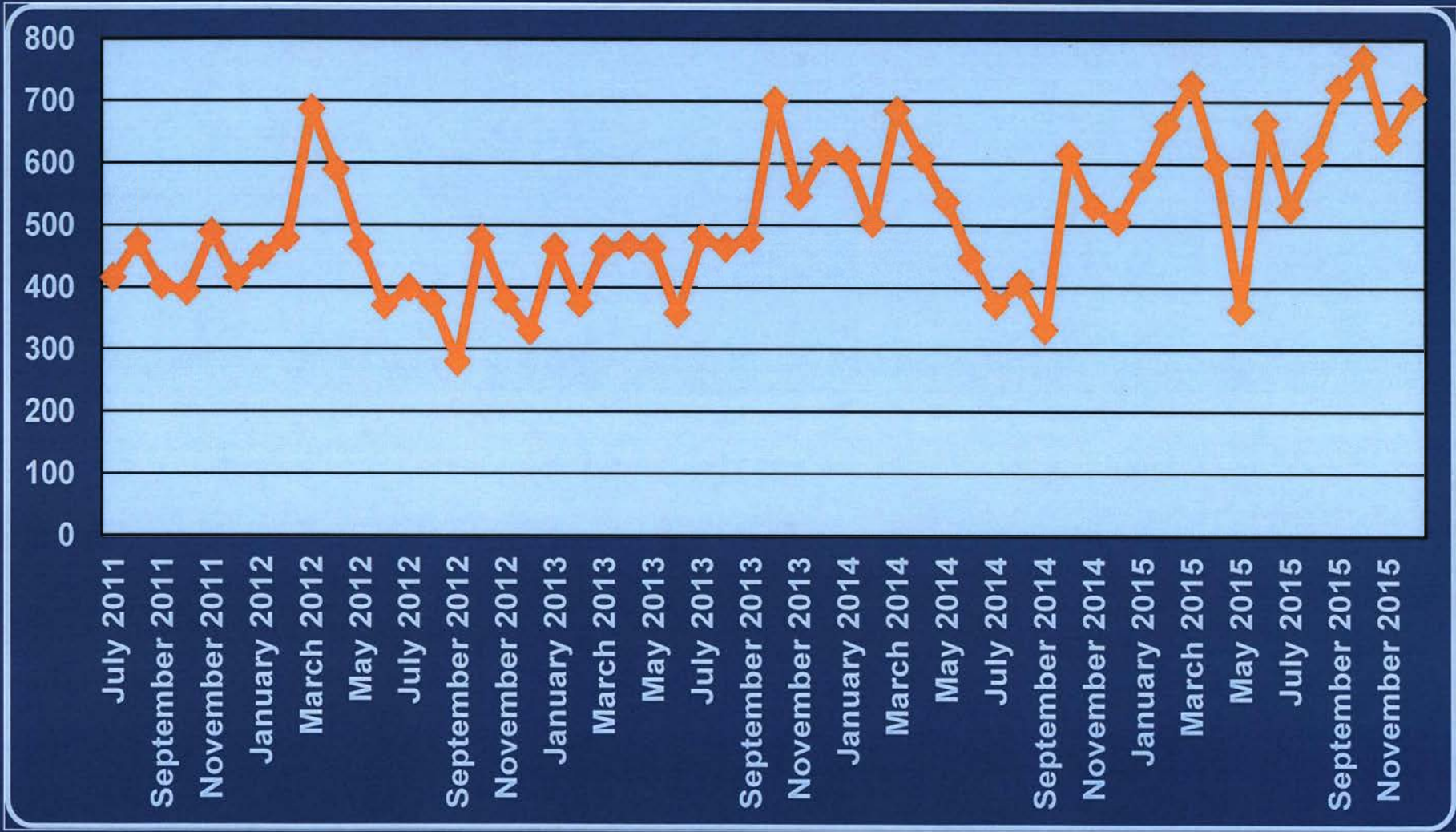

Multiple Solutions Necessary

Change parking behaviors

Increase transit

Encourage businesses to encourage transit

Allow parking structures

Short-term Solutions

Begin Downtown Trolley at 5:00 AM

Change 3-hour Parking Limit to 2-hour

Permit Parking for P-3 Properties

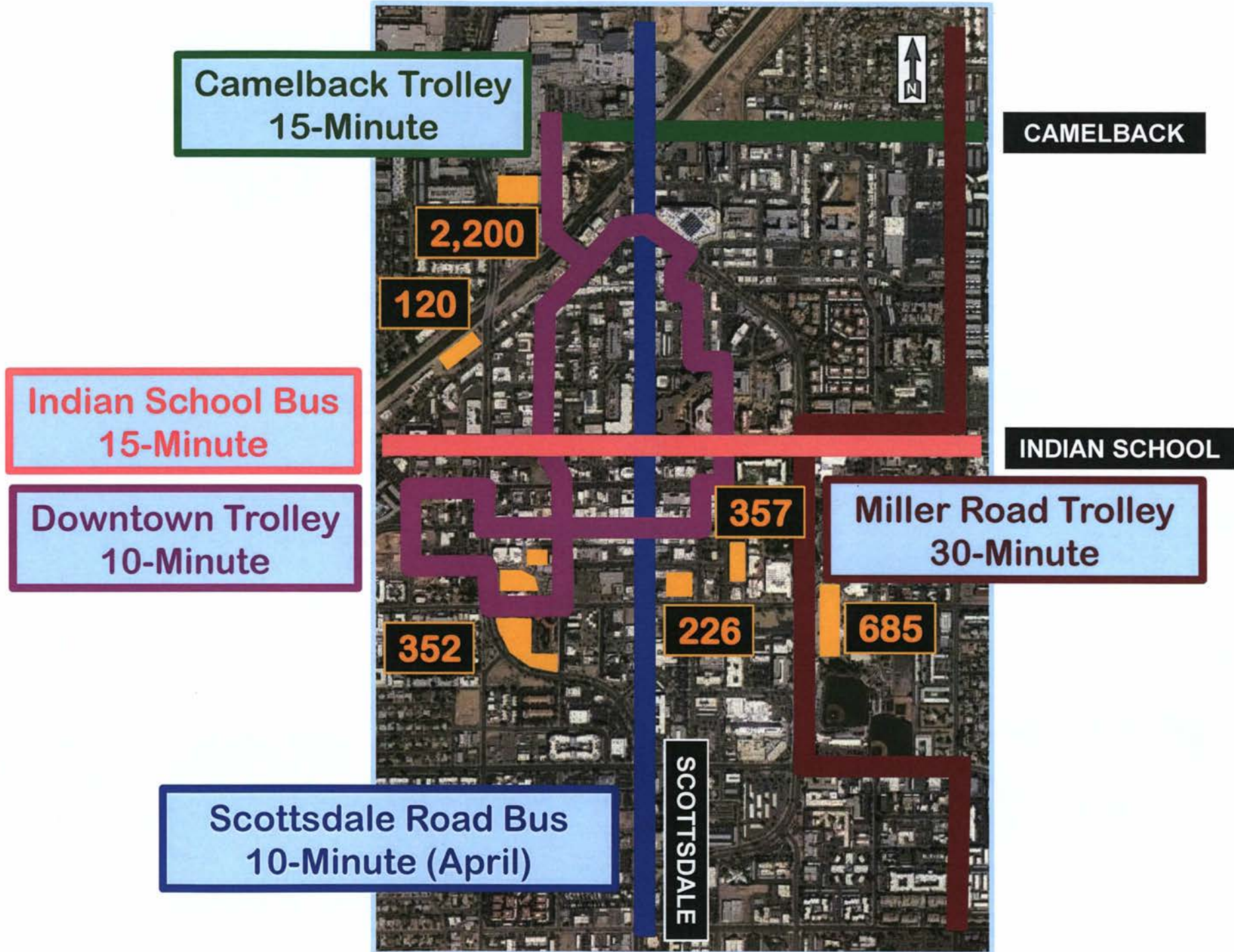

2-Hour Parking Maximum

Stop 3-hour Vehicle Rotation

Requires Additional Enforcement Budget

Permits for P-3 Properties

Allow all-day parking for identified vehicles

Fee requires revised ordinance

Mid-term Solution

**New privately-constructed and operated,
publicly-owned 770-space structure**

1,585 Spaces Credited

703 Available On-Street

770 New Structure

1,473 Provided

Requires zoning ordinance change

New Private Parking Structure



770 Parking-Space Structure



Other Potential Solutions

On-street Parking Meters

Credit Card and Sensor Technology

First 1 or 2 hours free

**Office Requirement of 6 parking spaces
per 1000-square-feet**

Rescind P-3 Parking credits

Other Potential Solutions

Other Parking Structure Financing

Bond

Improvement District

Community Facilities District

Business Facilities District

Sell Property requiring Parking Structure

Larger Parking Structure

Taller, Deeper, or Adjacent property

Seeking Direction

Downtown Trolley

Two-hour and Permit Parking

Privately funded 770-space Structure

Other Potential Solutions

Item 2

**Downtown Scottsdale Parking
Challenges and Solutions**

Tonight's Discussion

- 1. Downtown Parking History**
- 2. Current Challenges**
- 3. Parking Data**
- 4. Short-term Recommendations**
- 5. Mid-term Recommendations**

Downtown Parking History

1962: 1st Parking Ordinance and Exempt C-2
1964: Parking Overlay
1965: P-1 and P-2
1966: P-3
1967: Remove C-2 Exemption
1969: Comprehensive Zoning Ordinance
1970: On-Street Angle Parking Credit
1972: P-3 Parking Credit
1974: Parking Improvement Districts
1981: Remote Parking Provisions

Downtown Parking History

1985: In-Lieu Payment Parking Created
1995: Comprehensive Amendments
2003: Angle Parking Credit Removed
2003: Simplified Parking Requirements
2006: Parking Requirements Amendments

1,585 Parking Space Credits

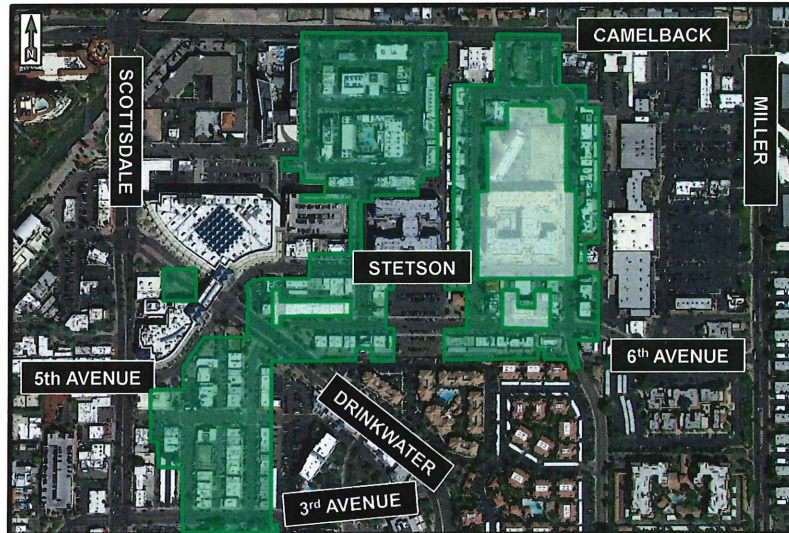

Changing Office Use

Nationally businesses use smaller individual offices with larger common areas

Competing cities have:

- Lower parking requirements**
- Subsidized parking availability**
- More transit options**

Consultant Parking Data

Detailed Downtown Parking Inventory
~ 20,000 Spaces Entire Downtown
~ Half Public, Half Private
Large number of 3-hour restricted spaces
Detailed Parking Occupancy counts
Validated and identified deficiencies

Consultant Parking Report

22 Nation-wide Best Practices
9-page Potential Solutions Discussion

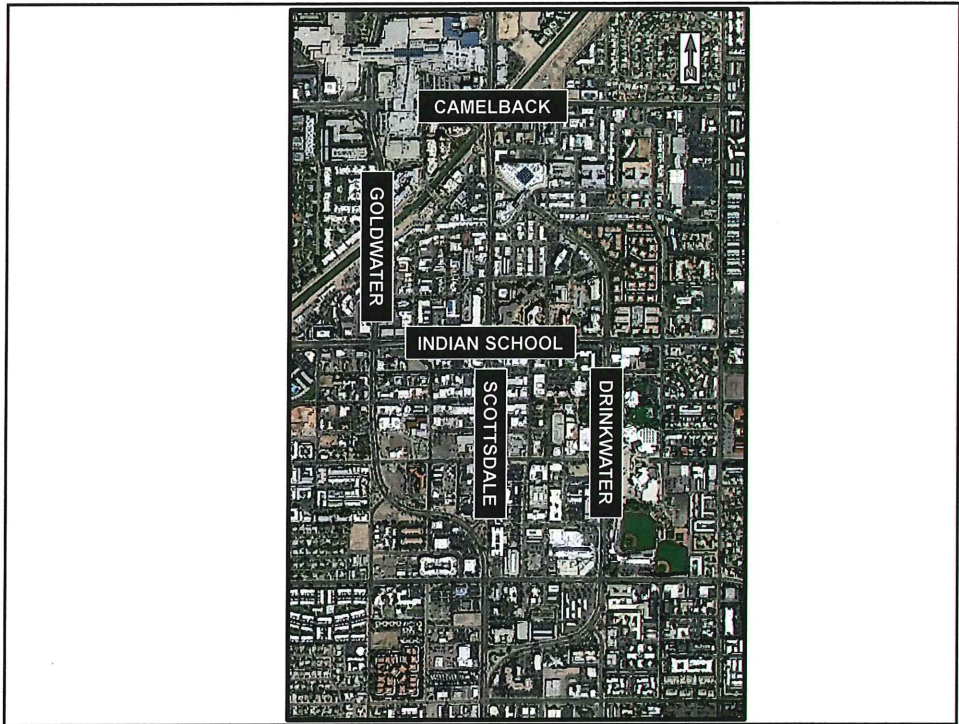

Northeast Downtown



Available Parking Spaces



5th Avenue Parking Structure

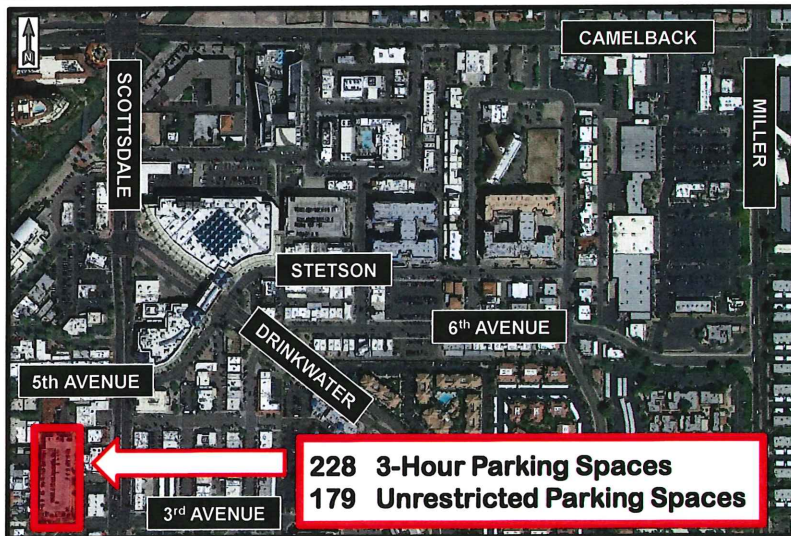

Downtown Parking Structures

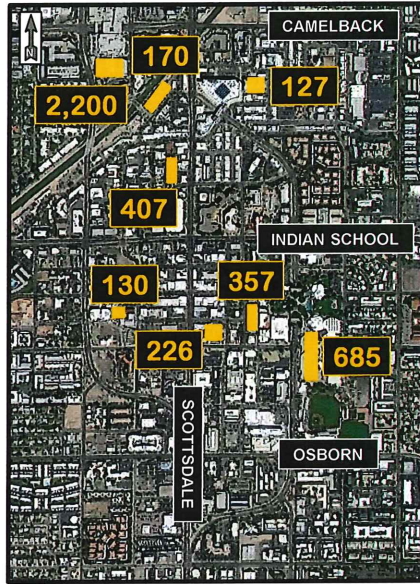

Historic Parking Citations

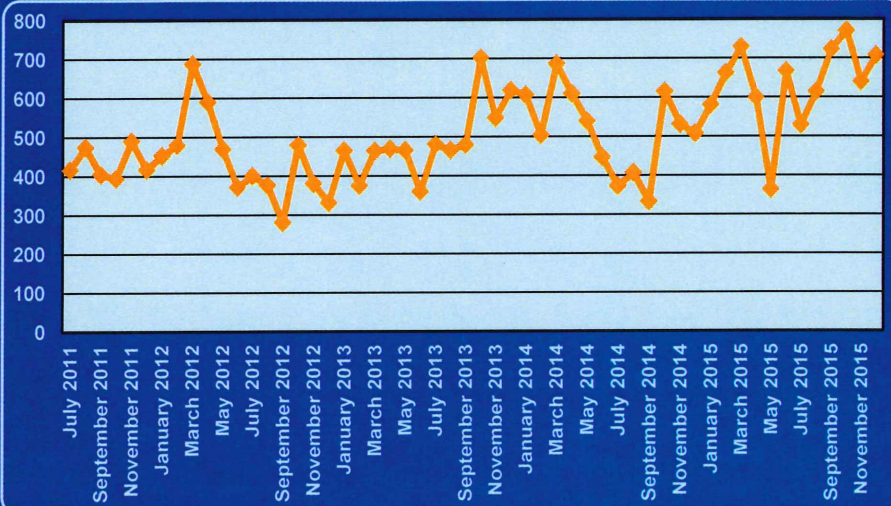

Multiple Solutions Necessary

**Change parking behaviors
Increase transit
Encourage businesses to encourage transit
Allow parking structures**

Short-term Solutions

**Begin Downtown Trolley at 5:00 AM
Change 3-hour Parking Limit to 2-hour
Permit Parking for P-3 Properties**

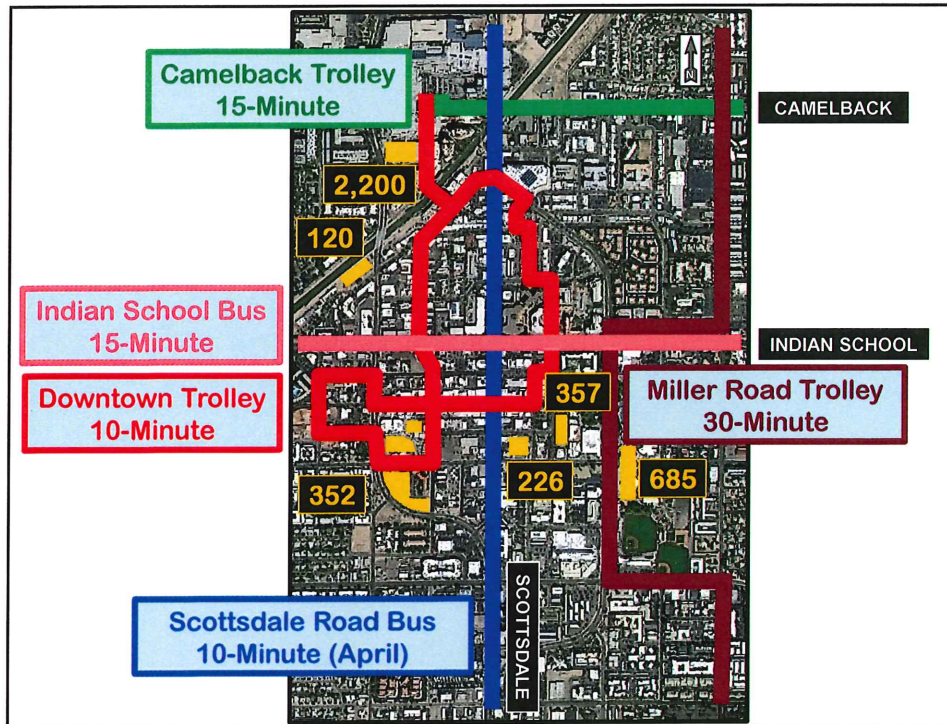

2-Hour Parking Maximum

Stop 3-hour Vehicle Rotation

Requires Additional Enforcement Budget

Permits for P-3 Properties

Allow all-day parking for identified vehicles

Fee requires revised ordinance

Mid-term Solution

**New privately-constructed and operated,
publicly-owned 770-space structure**

1,585 Spaces Credited

**703 Available On-Street
770 New Structure**

1,473 Provided

Requires zoning ordinance change

New Private Parking Structure

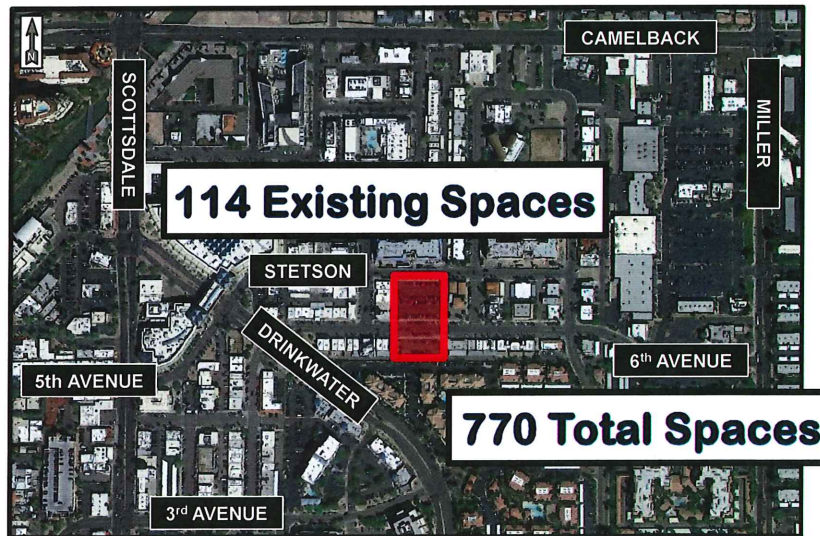

770 Parking-Space Structure

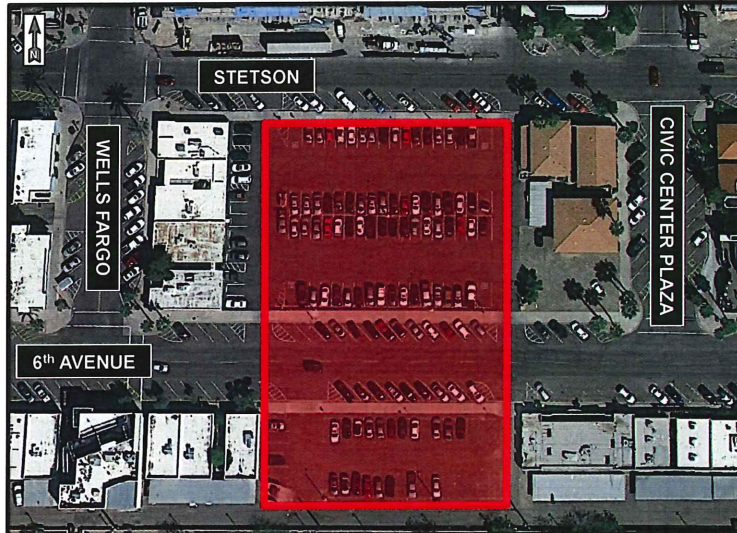

Other Potential Solutions

On-street Parking Meters

Credit Card and Sensor Technology

First 1 or 2 hours free

**Office Requirement of 6 parking spaces
per 1000-square-foot**

Rescind P-3 Parking credits

Other Potential Solutions

Other Parking Structure Financing
Bond
Improvement District
Community Facilities District
Business Facilities District
Sell Property requiring Parking Structure

Larger Parking Structure
Taller, Deeper, or Adjacent property

Seeking Direction

Downtown Trolley
Two-hour and Permit Parking
Privately funded 770-space Structure

Other Potential Solutions