

ZONING INTERPRETATION RECORD

Subject of Interpretation: Walls, fences and hedges on single family corner lots

Zoning Ordinance Section Number: R1-190 R1-70 R1-43 R1-35
R1-18 R1-10
*5.014 G., 5.034 G., 5.104 G., 5.204 G.,
5.304 G., 5.404 G.

Title of Section: Buildings, walls, fences and landscaping

Cause for Interpretation: Location of walls on corner lots in yards facing the side street has been inconsistently applied.

Interpretation: Where a corner lot does not abut a key lot, the height of walls, fences and hedges in the yard facing the side street need only conform to the side yard requirements which allows walls eight (8) feet high or less to be constructed on the property line or within the required side yard.

*Sec. 5.014 (R1-190) allows walls, fences, and hedges up to 12 feet in height with additional setbacks.

Lisa Collins 10/29/91 _____
Interpretation by Date Approved By

Walls / Fences / Hedges on Single Family Corner Lots

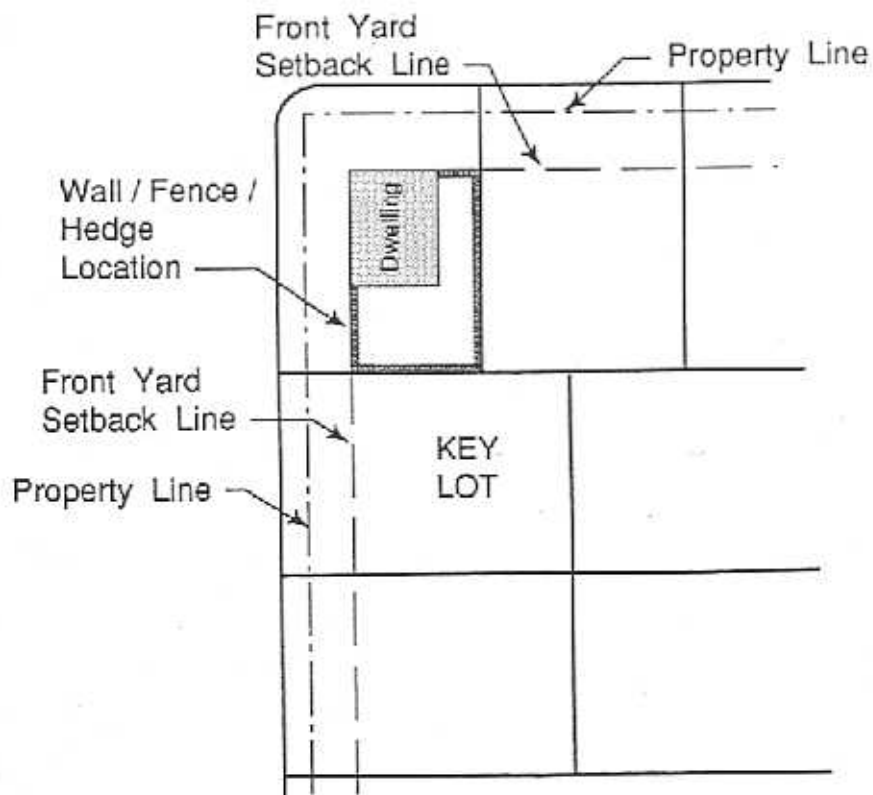
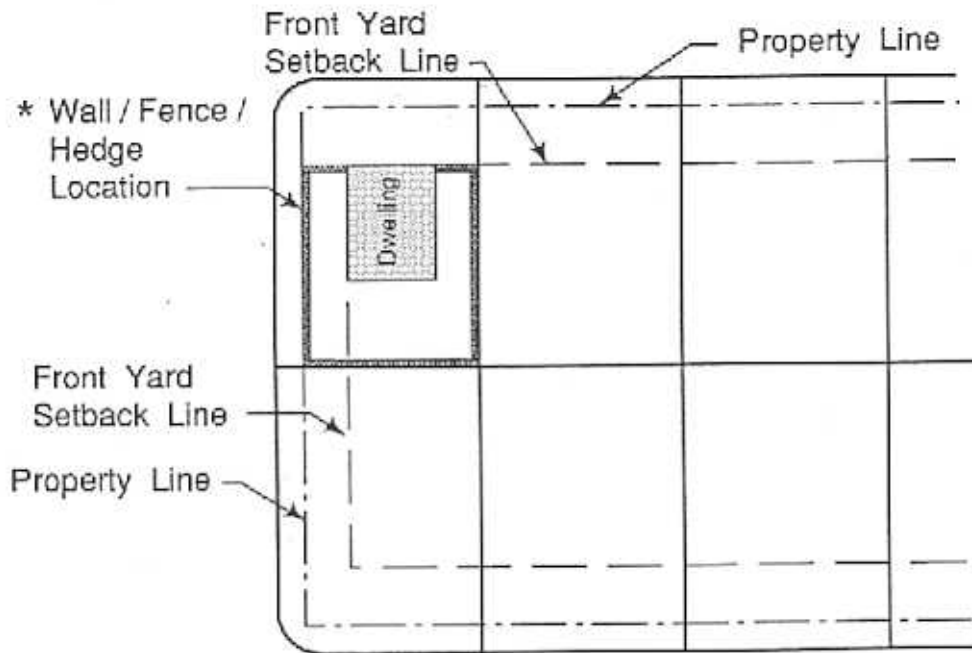

- * Sec. 7.104
Height limitations on fences, hedges, shubbery, etc. on corner lots shall apply.